

## GENERAL SPECIFICATIONS

- weight: approx. 48g per clutch
- contactless, on-axis hall sensor position measurement
- true linear output
- no moving electronic parts for unlimited operation
- smooth operation due to pre-tensioned ball bearing design
- zero play -> off-center actuation & asymmetric paddles possible

## ELECTRICAL SPECIFICATIONS

- 3.3V (factory default) or 5.0V DC supply voltage
- operating conditions 3.3V mode: 3.0V - 3.6V
- operating conditions 5.0V mode: 4.5V - 5.5V
- output signal: analog voltage, ratiometric to VDD
- output range: approx. 6% to 94% VDD
- 12-bit DAC resolution (4096 steps/ <0.01mm paddle movement)
- noiseless output due to on-sensor filtering & hysteresis
- extremely low power consumption (approx. 1mA per clutch)
- electrostatic discharge HBM: ±1 kV

## ENVIRONMENTAL SPECIFICATIONS

- temperature range: -40°C to 125°C
- IP67 waterproof (use gasket paper for full spec.)

use gasket paper to achieve full water proofing

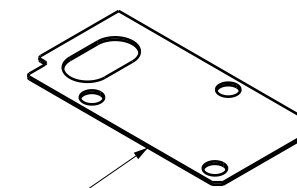

5.0V supply:  
remove jumper!

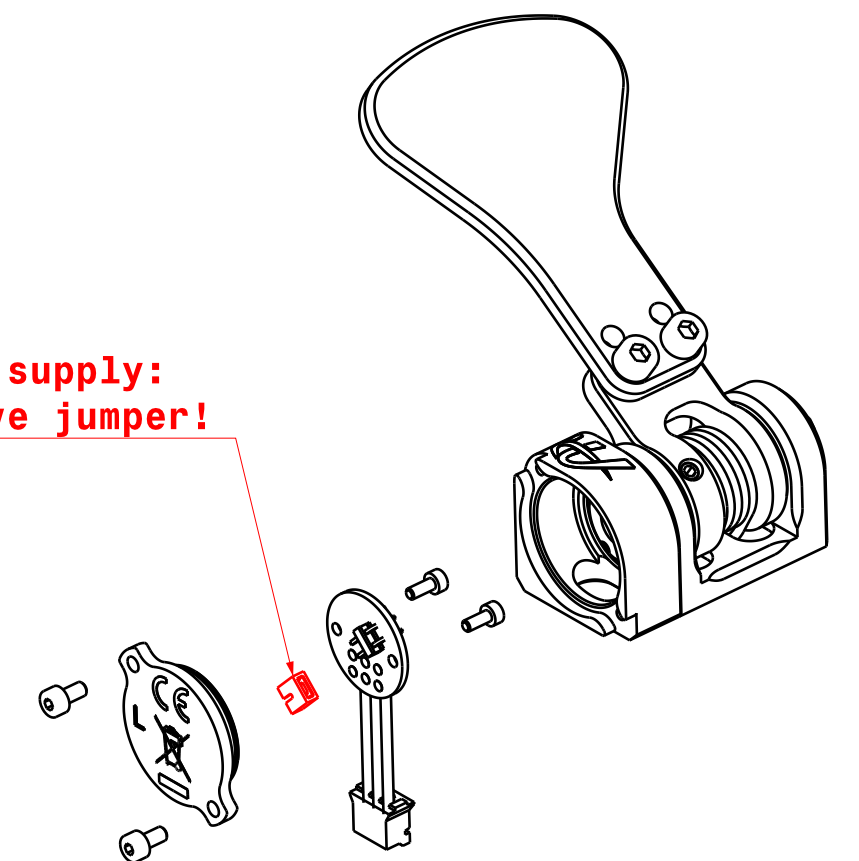

matching connectors	THT	SMT
JST PH-series		
top entry type	B3B-PH-KL	B3B-PH-SM4-TB
side entry type	S3B-PH-KL	S3B-PH-SM4-TB

PIN 1	GND	black
PIN 2	signal output	yellow
PIN 3	3.3V* (5.0V)**	red

\* factory default setting  
\*\* for 5.0V supply voltage, remove jumper!

V1		electr. data		Allgemein-Toleranzen ISO 2768-m		Oberflächen ISO 1302		Maßstab:		Gewicht:	
				Datum		Name		Blatt		1	
				Bearb. 29.07.22		Ascher		76080024		1 Bl.	
				Gepr.				Clutch_Gen4			
				Norm							
Zust.	Änderung	Datum	Name								